

Route 286

Updated: December 2011

1969 Legislature:

This route re-designated SR-286 by the **1969 Legislature** (prior to 1969 this route was designated SR-183).

1969 Description:

From SR-235 to the State Industrial School in Ogden.

*(A)

1983 Legislature: Description remains the same.

1985 Legislature: Description remains the same.

1986 Legislature: Description remains the same.

1987 Legislature: Description remains the same.

1988 Legislature: Description remains the same.

1990 Legislature: Description remains the same.

1992 Legislature: Description remains the same.

1993 Legislature: Description remains the same.

1994 Legislative Description:

From Route 235 to and including a peripheral road at the State Industrial School in Ogden.

1995 Legislature: Description remains the same.

1996 Legislature: Description remains the same.

1997 Legislature: Description remains the same.

1998 Legislature: Description remains the same.

1999 Legislature: Description remains the same.

2000 Legislature: Description remains the same.

2001 Legislature: Description remains the same.

2002 Legislature: Description remains the same.

2003 Legislature: Description remains the same.

2004 Legislature: Description remains the same.

2005 Legislature: Description remains the same.

2006 Legislature: Description remains the same.

2007 Legislature: Description remains the same.

2008 Legislature: Description remains the same.

2011 Legislature: Description remains the same.

* Refers to resolution index page following.

Route 286

COUNTY/VOLUME & RESOLUTION NUMBER

A. Weber Co. 4/8

DESCRIPTION OF RESOLUTION CHANGE

(A). Addition - Peripheral Road around Utah State Industrial School.

SR-286

Weber

8

File

RESOLUTION

State Route 286

WHEREAS, to clarify State Department of Highways maintenance responsibility for those roads within the Utah State Industrial School at Ogden, in Weber County, and

WHEREAS, the construction of Project NR-286(1) is resulting in the construction of a peripheral road around the school, and

WHEREAS, it has been requested by the Utah State Industrial School and concurred in by Mr. W. E. Mickelson, District Engineer, that this roadway be considered as part of the State System of Highways.

NOW THEREFORE, be it resolved as follows:

That the roadway, State Route 286, as reflected on the attached map sheet be hereby designated as a part of the State System of Highways,

That by this action State Highway mileage will increase 0.7 + - mile.

That the letter from the Utah State Industrial School and the memorandum from Mr. Mickelson pertaining to the aforementioned action be hereby incorporated as a part of this submission.

That the map illustrating the action taken herewith be hereby incorporated as a part of this submission.

Dated this 5th day of November, 1971.

STATE ROAD COMMISSION OF UTAH

Clayton H. Church
Chairman

B. LaJean Cox
Vice-Chairman

RESOLUTION
State Route 286
Page 2

Lee H. Hunt
Commissioner

Frank D. Cook
Commissioner

William H. Hunter
Commissioner

ATTEST:

Ronald A. Zumbly
Secretary

U-460

Memorandum

UTAH STATE DEPARTMENT OF HIGHWAYS

DATE: Sept. 21, 1971

TO : Howard B. Leatham, P.E.
Engineer for Planning and Programming

FROM : W.E. Mickelson, District Engineer, District One *W.E. Mickelson*

SUBJECT: Utah State Industrial School Peripheral Road - NR-286(1)
Length: 1.20 Miles

The subject project is presently under contract with Fife Rock Products of Brigham City.

The attached letter from Mr. Claud H. Pratt, superintendent at the Industrial School, constitutes a request for the roads being constructed under this project to become part of the state road system.

The district concurs in this matter and requests that the necessary approvals be obtained to comply with Mr. Pratts request.

The attached map is a diagram of the designated peripheral road.

Attachment

RECEIVED
Utah State Department of Hiways
Transportation Section
SEP 24 1971
AM 7 8 9 10 11 12 1 2 3 4 5 6 PM
▲



Utah State Industrial School

BOX 41
OGDEN, UTAH

CLAUD H. PRATT
SUPERINTENDENT

ADDRESS ALL COMMUNICATIONS TO SUPERINTENDENT

September 14, 1971

Mr. W. E. Mickelson
District Engineer
District # 1 Engineer's Office
128 - 17th Street
Ogden, Utah

Dear Mr. Mickelson:

I am requesting that the new peripheral road, approximately one mile in length, around the campus of the State Industrial School be added to the State road system and all necessary maintenance and repairs be provided through your department. This request would cover not only the new section of road now being constructed, but the existing section of the peripheral road.

The design and engineering work, drawing of specifications and supervision of this project has been through the State Highway Department. Fife Construction Company is constructing the road.

We appreciate the help that the State Highway Department has given, and we trust that you may be able to comply fully with this request.

Sincerely,

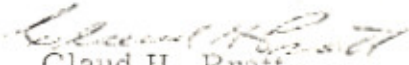
Claud H. Pratt
Superintendent

CHP:djb

SEP 16 1971
128 - 17th Street
OGDEN, UTAH

SR-286
Webster

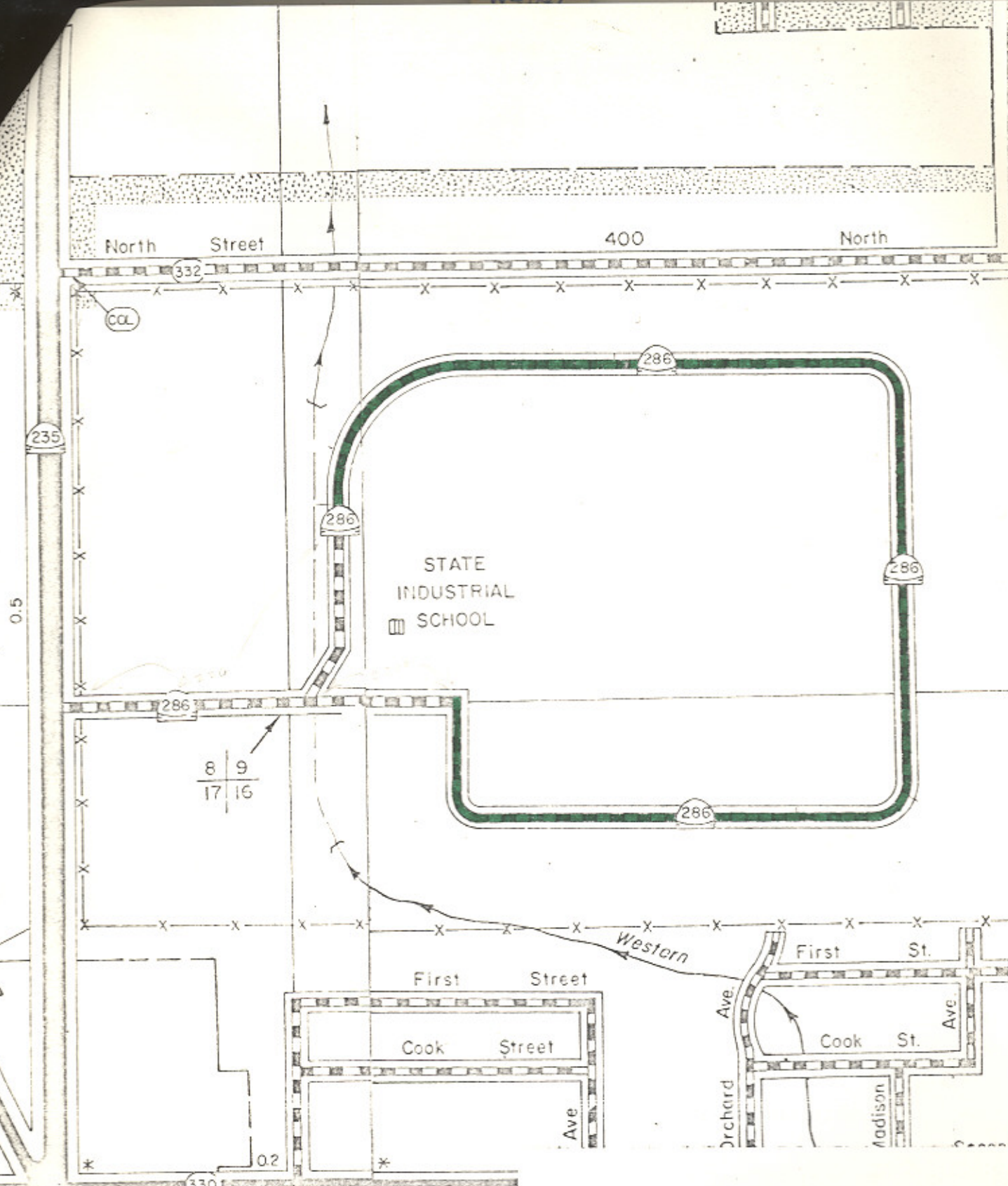

UTAH STATE DEPARTMENT OF HIGHWAYS
Systems Planning Division

STATE ROAD CHANGES
OGDEN CITY

- Addition to State Road System
- ~~—~~ Deletion from State Road System
- - - Transferred to Local Jurisdiction

UTAH STATE DEPARTMENT OF HIGHWAYS

bc: Howard B. Leatham, Engineer for Planning & Programming

Information sent to: W. E. Mickelson, District Engineer

Jerry Fenn	Maurice RiChey	Ellen Wandell	Charles Bertolina
Ralph Murdock	Clarence Stephens	Harold Brown	Jim West
Dean Steed	Evelyn Crill	Ray Behling	Don Jensen
Porter M. Gooch	Wallace Liddle	Bonnie Garcia	Clarence Bywater
Keith Rosevear	David Sargent	John W. Homer	Ken Riddle
Robert Walsh	Art Geurts	Chauncey Powis	Winston Neiman
Lillian Witkowski	Ezra Christensen	Bert Kros	

November 11, 1971

Mr. Claud H. Pratt, Superintendent
Utah State Industrial School
P. O. Box 41
Ogden, Utah 84104

Dear Mr. Pratt:

Subject: Utah State Industrial School Peripheral Road

Effective November 5, 1971, the State Road Commission adopted a resolution to add to the State System of Highways that portion of roadway described in the attached resolution as a part of State Route 286.

Transmitted is a copy of the resolution and a location map.

Very truly yours,

L. R. Jester, P.E.
Chief, Systems Planning Division

Transmittal